



10 Wilton Close
Kettering, NN14 2QJ



A spacious three-bedroom semi-detached home set on a generous plot, with off-road parking and a garage, positioned at the end of a quiet cul-de-sac. Offering excellent potential, the property features a versatile ground floor layout including a good-sized lounge and a separate dining room with direct access onto the garden. There is also a side extension off the kitchen, currently used as a snug with an additional W/C. Upstairs provides three well-proportioned bedrooms, a family bathroom and separate W/C. While requiring modernisation, this home presents a fantastic opportunity to extend (STPP) and create a bespoke family space. Externally, the property boasts a beautifully maintained, mature garden—ideal for relaxing or entertaining. A superb opportunity with huge potential—early viewing highly recommended. Internal photos for the property to follow.

£225,000

3 2 3



Ground Floor

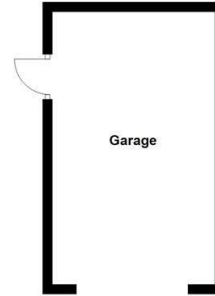

First Floor

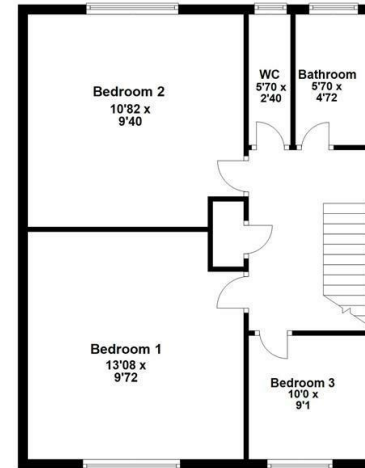

Energy Efficiency Rating

	Current	Potential
<i>Very energy efficient - lower running costs</i>		
(92 plus) A		
(81-91) B		
(69-80) C		
(55-68) D		
(39-54) E		
(21-38) F		
(1-20) G		
<i>Not energy efficient - higher running costs</i>		
England & Wales	EU Directive 2002/91/EC	





**Simpson
Ellson**

T: 01536 645960
E: rothwell@simpsonellson.co.uk



01536 645960
rothwell@simpsonellson.co.uk
<https://www.simpsonellson.co.uk>

32 High Street, Rothwell, Northants, NN14 6BQ